

I-RACKS

UFO 2+1

OWNER'S MANUAL

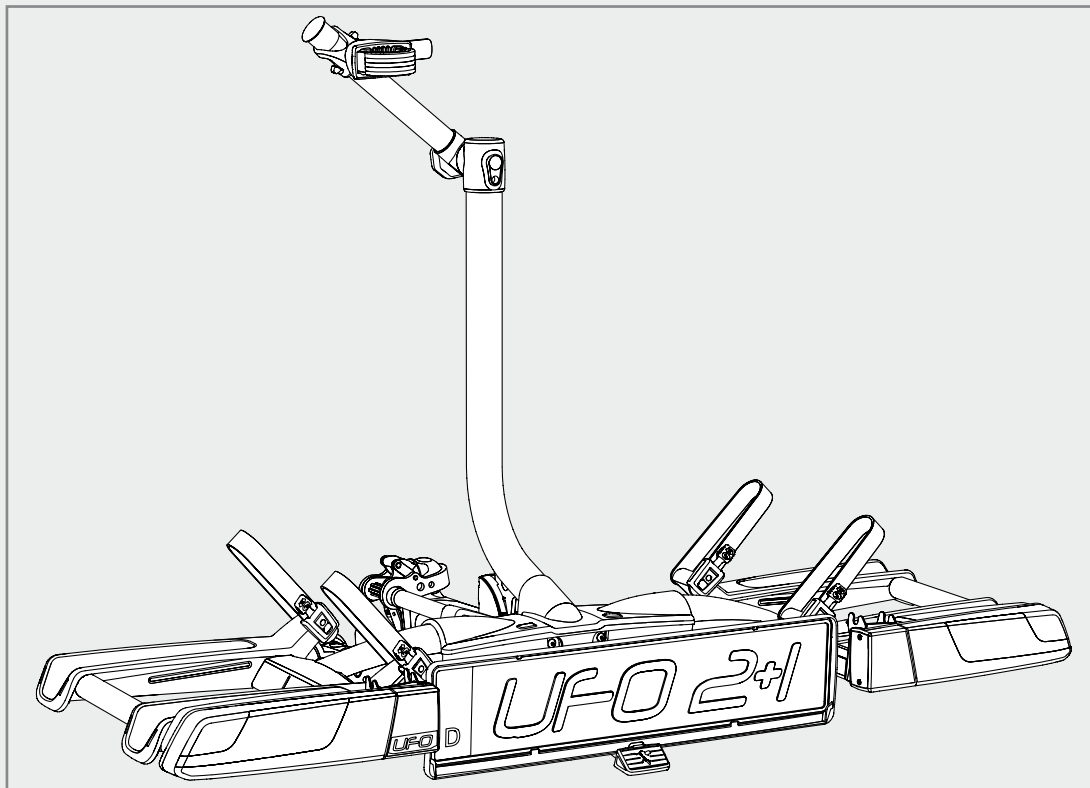

INTRODUCTION

Foreword	4
Legend.....	4

TECHNICAL DATA

Load table.....	7
-----------------	---

SAFETY

Intended use.....	8
-------------------	---

Basic safety instructions	8
... installation & maintenance ..	9
... loading	10
... transport	10

INSTALLATION

Attaching rear-mounted carrier to the vehicle	12
Attaching the carrier	12
Connecting the carrier.....	13
Clamping & locking the carrier	15
Inserting number plate.....	17
Third brake light.....	17
Removing rear-mounted carrier from the vehicle	18
Unlocking support arms	19

IN USE

Loading rear-mounted carrier ..	22
Using coupling head	22
Operating wheel retainer strap	24
Attaching first bicycle	24
Attaching second bicycle	25
Attaching third bicycle	26
Pivoting rear-mounted carrier ..	26

MAINTENANCE

Replacing lights	28
Intervals	29

APPENDIX

Type approval	32
---------------------	----

INTRODUCTION

FOREWORD

This Owner's Manual is part of your I-RACKS product and contains information on correct installation, safe use and maintenance. Read the Owner's Manual closely before installing or using your I-RACKS product. Follow all directions for installation, operation and maintenance in this manual.

WARNING



Ignoring the instructions in this manual may result in accidents with fatal consequences or serious injury.

Keep this manual in the vehicle on which your I-RACKS product is installed.

Keep this manual for other users of your I-RACKS product. Make sure that every user reads, understands and follows this manual.

If you ever sell or give away your I-RACKS product, give this manual to the new owner.

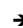
LEGEND

-  The pointed finger prompts you to perform an action.
-  The arrow indicates consequences or requirements.
-  This note shows additional information or tips.

WARNING

This note warns of a hazardous situation, which, if not prevented, may result in death or serious injury.

CAUTION

This note warns of a hazardous situation, which, if not prevented, may result in moderate or minor injury.

NOTICE

This note warns of imminent material damage.

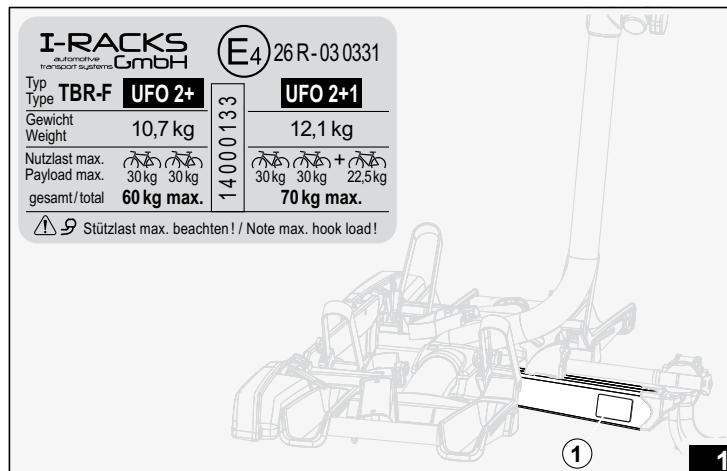

The illustrations in this manual may differ from your I-RACKS product, but the required work steps are the same for all models – unless otherwise specified.

The type plate (1) for your I-RACKS rear-mounted bicycle carrier is on the right of the centre tube (fig. 1).

Please note that the driving characteristics of your motor vehicle will be affected by the installation of your new I-RACKS rear-mounted bicycle carrier.

Familiarise yourself with the different characteristics (braking distance, curves, sensitivity to side winds etc.) during your first trips with the carrier installed.

See **www.i-racks.de** for many more tips and information about your I-RACKS product and also accessories and spare parts. You can also contact the I-RACKS team there directly.

We wish you happy travels and enjoyable bike riding.

The I-RACKS Team

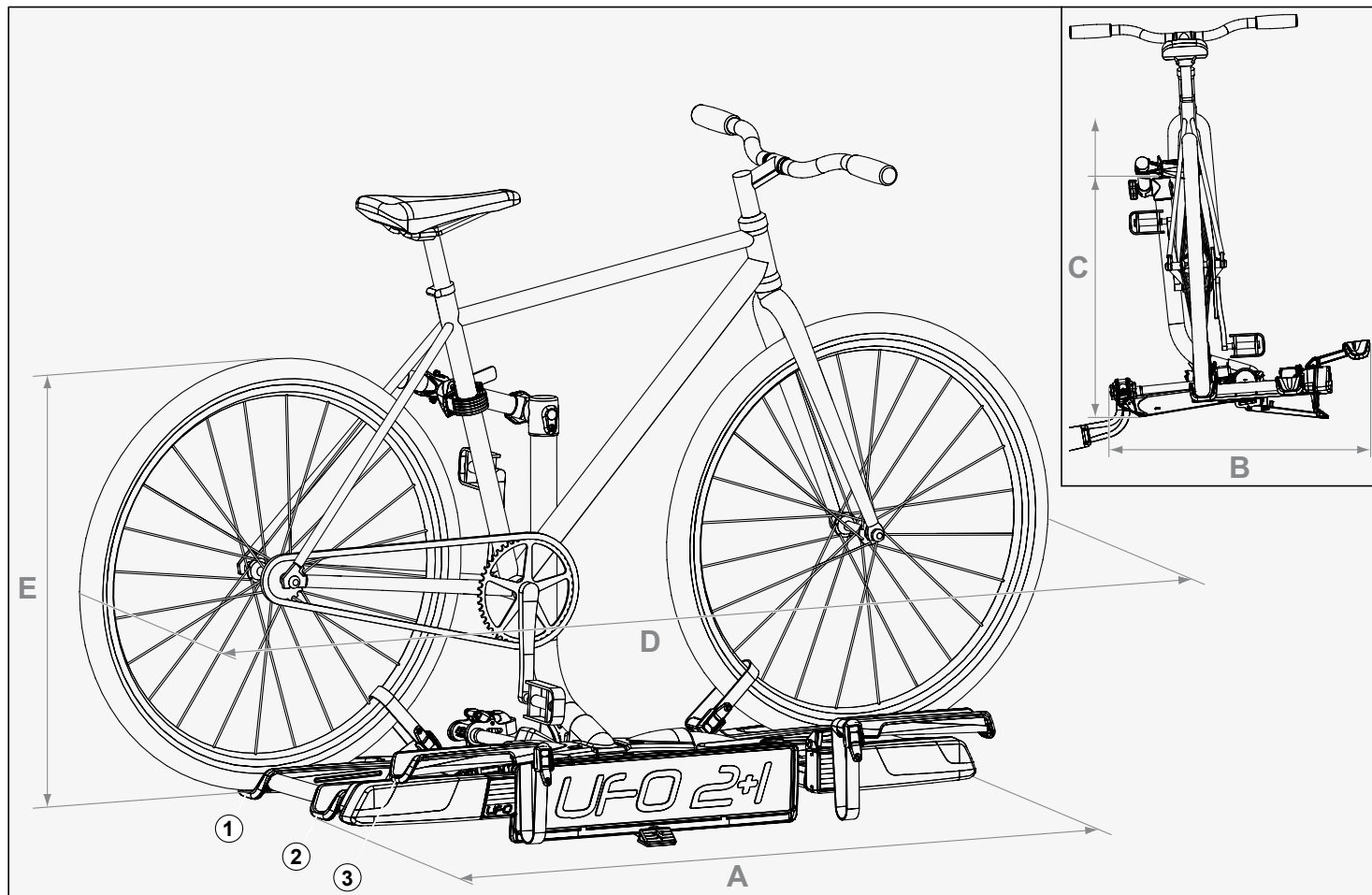

			UFO 2+	UFO 2+1
	Capacity		2 bicycles *	3 bicycles
A	Width	mm	1171	
B	Length (extension)		590	688
C	Height		637–853	
D	Length of bicycle, max.		1937	
E	Bicycle wheel size, min.–max.		18"–28" (ETRTO 355–622)	
	Tyre width, max.		2.5" (ETRTO 62)	
	Unladen weight	kg (lb)	10.7 (23.6)	12.1 (26.7)
(1)	Load on rack 1, max.		30 (66.1)	
(2)	Load on rack 2, max.		30 (66.1)	
(3)	Load on extension, max.		–	22,5 (49.6)
	Total payload, max.		60 (132.3)	70 (154.3)

LOAD TABLE

TRAILER HITCH		UFO 2+	UFO 2+	UFO 2+1	UFO 2+1
Hook load max. kg (lb)	D-value min. kN	Weight kg (lb)	Load** max. kg (lb)	Weight kg (lb)	Load** max. kg (lb)
40 (88.2)	7.6 ***	10.7 (23.6) + 0.2 (0.4) ****	29.1 (64.2)	12.1 (26.7) + 0.2 (0.4) ****	27.7 (61.1)
45 (99.2)			34.1 (75.2)		32.7 (72.1)
50 (110.2)			39.1 (86.2)		37.7 (83.1)
55 (121.3)			44.1 (97.2)		42.7 (94.1)
60 (132.3)			49.1 (108.2)		47.7 (105.2)
65 (143.3)			54.1 (119.3)		52.7 (116.2)
70 (154.3)			59.1 (130.3)		57.7 (127.2)
75 (165.3)			60 (132.3)		62.7 (138.2)
80 (176.4)					67.7 (149.3)
85–175 (187.4–385.8)					70.0 (154.3)

* Can be expanded for 3rd bicycle.

** Total of all bicycles.

*** With a D-value less than 7.6 kN – see **INTENDED USE**, page 8.

****Number plate.

INTENDED USE

WARNING

Use in traffic other than the intended use may result in accidents with fatal or serious injury.

The UFO rear-mounted bicycle carrier is designed and intended exclusively

- for installation on motor vehicles with trailer hitches with a ball coupling with an EEC type approval in accordance with Directive 94/20/EC and with an allowable hook load that must not be less than the total weight of the bicycle carrier (carrier + transported bicycles) – ball couplings of aluminium or cast iron (GGG40) are specifically prohibited.
- for installation on a trailer hitch with a D-value that must be at least 7.6 kN *.
- for connection of a standards-compliant 13-pole trailer socket (12 V).
- for combination with the I-RACKS expansion kit for 3rd bicycle (UFO 2+).
- for combination with original I-RACKS accessories.
- for support and transport of 2 (UFO 2+) or 3 standard bicycles (3rd bicycle only with the I-RACKS attachment kit for 3rd bicycle or UFO 2+1) with a wheel diameter between 18" and 28" (including "29-er") and up to a length of 1937 mm – tandems, recumbent bikes and other special types of bicycles are specifically prohibited.

* Under some circumstances you can also install your rear-mounted bicycle carrier on trailer hitches with a lower D-value.
For help with checking your trailer hitch see www.i-racks.de
or by telephone at +49 7502 912 436 4

BASIC SAFETY INSTRUCTIONS ...

Your rear-mounted bicycle carrier has the European type approval (ETG) with the number: E4 26R-03 0331. Additional TÜV inspection is not required – see **APPENDIX**, page 32.

Under German traffic regulations (StVZO) an additional number plate must be attached to your rear-mounted bicycle carrier – the additional number plate does not require a TÜV sticker or registration sticker.

It may be necessary to install a 3rd brake light – see **THIRD BRAKE LIGHT**, page 17.

Note that the driver of the vehicle is always responsible for correct installation of your rear-mounted bicycle carrier on the vehicle.

Observe the regulations of other countries regarding the use of your rear-mounted bicycle carrier (warning signs, lights, speed limits etc.).

... installation & maintenance

⚠ WARNING

Risk of accident due to failure of rear-mounted carrier because of faulty or unapproved installation or maintenance.

- Do not overestimate your technical expertise. In case of doubt have your rear-mounted carrier installed and maintained by a specialist bicycle or vehicle workshop. This will guarantee professional work.
- Before starting to install your rear-mounted carrier, make sure that the coupling ball of the trailer hitch is clean and grease-free and that it is not covered by foil or a coating.
- Follow the installation instructions in the Owner's Manual in the specified sequence.
- Never try to install the rear-mounted carrier other than as described.
- Never make any modifications to the rear-mounted carrier (e.g. filing, drilling, painting etc.).
- Never try to disassemble the rear-mounted carrier.
- Use original I-RACKS accessories only.
- Comply with all specified min./max. values (load weight, total dimensions etc.) – see **TECHNICAL DATA**, page 6.
- Make sure that the specified maximum vehicle loads are never exceeded (hook load, axle loads) – see type plate on trailer hitch or vehicle registration papers.
- Always keep your rear-mounted carrier clean and in good technical condition.

NOTICE

Damage to vehicle rear hatch by contact with rear-mounted carrier or bicycle on carrier.

- Make sure that the rear hatch does not contact the rear-mounted carrier when it is pivoted aside or a bicycle is loaded on the carrier.
- If necessary, disable the automatic hatch opener on your vehicle for additional safety. This will prevent the hatch from opening if the rear-mounted carrier is not swung aside.

Damage to rear-mounted carrier or loaded bicycle due to hot exhaust gases.

- Make sure that your rear-mounted carrier and loaded bicycles are sufficiently clear of the exhaust tail pipe.

SAFETY

... loading

WARNING

Risk of accident due to parts falling off due to incorrect or non-approved loading.

- Always comply with all specified min./max. values (load weight, maximum dimensions etc.) – see **TECHNICAL DATA**, page 6.
- Remove loose or attached accessories from the bicycles (air pump, drink bottle, speedometer, battery etc.).
- Remove larger accessories from the bicycles (child seat, luggage carriers, baskets etc.).
- Never wrap the bicycles in foil, tarpaulins or similar items.
- Before starting, always make sure that the bicycles are securely and correctly attached at all fastening points of your rear-mounted carrier and are not damaged (cracks, deformation etc.).
- If you wish to load several bicycles on your rear-mounted carrier, always load the heaviest bicycle first. If different bicycles weigh the same, start with the largest.

NOTICE

Damage to carbon parts by overload

- If necessary, contact the manufacturers of the carbon components (frame, forks, wheels) of the bicycles to ensure that they are suitable for transport on your rear-mounted carrier or whether specific measures are required to fasten them to the carrier to prevent damage.

... transport

WARNING

Risk of accident due to parts failure.

- Before every trip make sure that your rear-mounted carrier is securely and correctly mounted and that it cannot be pivoted on the trailer hitch. Repeat these checks at regular intervals during the trip. Never drive with a loose rear-mounted carrier.
- Before every trip make sure that the fastening components of your rear-mounted carrier are undamaged (cracks, deformation etc.). Repeat these checks at regular intervals during the trip. Never drive with damaged fastening components.
- Before every trip make sure that the bicycles are securely and correctly fastened at all fastening points of your rear-mounted carrier and that there is no damage at these points (cracks, deformation etc.). Repeat this check at regular intervals during the trip. Never drive with damaged fastening points.
- Before every trip make sure that the pivot mechanism of your rear-mounted carrier is correctly locked in the driving position.
- Before every trip make sure that the lights on your rear-mounted carrier and your vehicle operate correctly.

Risk of accident due to incorrect driving.

- Familiarise yourself with the changes in the driving characteristics of your vehicle in curves and during braking and the different dimensions with a mounted and loaded rear-mounted carrier.
- Expect increased sensitivity to side winds with your rear-mounted carrier mounted and installed.
- Never exceed a maximum speed of 130 km/h (80 mile/h).
- Reduce speed on rough surfaces.

NOTICE

Damage to other vehicles or to the rear-mounted carrier.

- Drive carefully when parking and manoeuvring and in parking garages and other restricted spaces - if necessary, have another person direct you.
- Always remove your rear-mounted carrier from the vehicle if you don't need it - this will also prevent increased fuel consumption.
- Never enter a car wash with your rear-mounted carrier mounted.

In addition to these basic safety instructions, use your common sense and drive carefully.

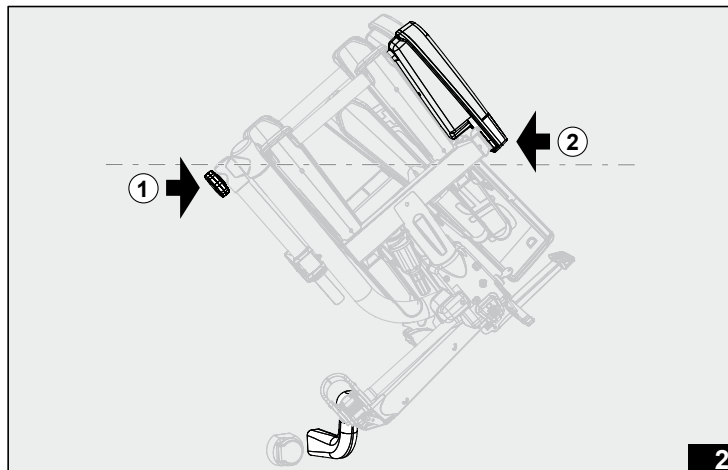

ATTACHING REAR-MOUNTED CARRIER TO THE VEHICLE

Attaching the carrier

- ① Your I-RACKS rear-mounted bicycle carrier has a very strong and precisely fitted retention and clamping mechanism, which securely fastens the rear-mounted carrier to the trailer hitch of your vehicle.

Mounting your rear-mounted carrier on the trailer hitch for the first time may require some patience. However, once you are familiar with the characteristics of the retention mechanism you will find the mounting process quick and easy.

See www.i-racks.de for detailed video instructions for installing and using your I-RACKS rear-mounted bicycle carrier.

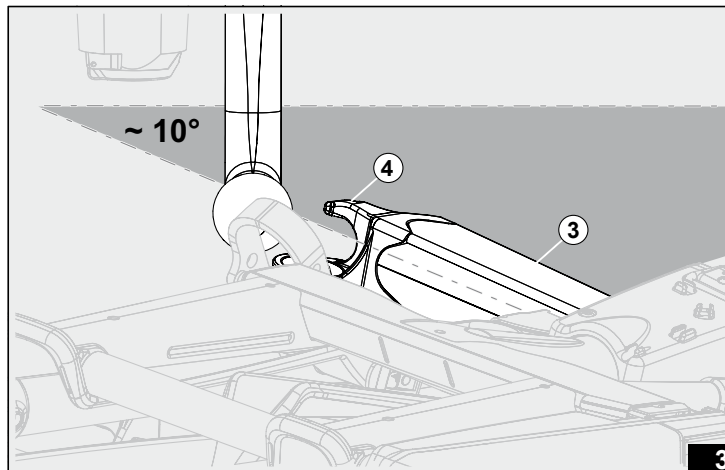

⚠ WARNING

Risk of accident due to failure of rear-mounted carrier because of faulty or unapproved installation or maintenance.

– Read and follow the **BASIC SAFETY INSTRUCTIONS** – See ... **INSTALLATION & MAINTENANCE**, page 9.

- ☞ Grip your rear-mounted carrier by the star handle (1) of the jointed arm with your left hand and the bottom of the rear light housing with your right hand (2) (fig. 2).
- ☞ Stand behind the trailer hitch of your vehicle.
 - ➔ Your hands and the retention points of your rear-mounted carrier will be at about the same height (fig. 2).
 - ➔ The centre tube (3) of your rear-mounted carrier will be at an angle of about 10° to the rear bumper of your vehicle (fig. 3).

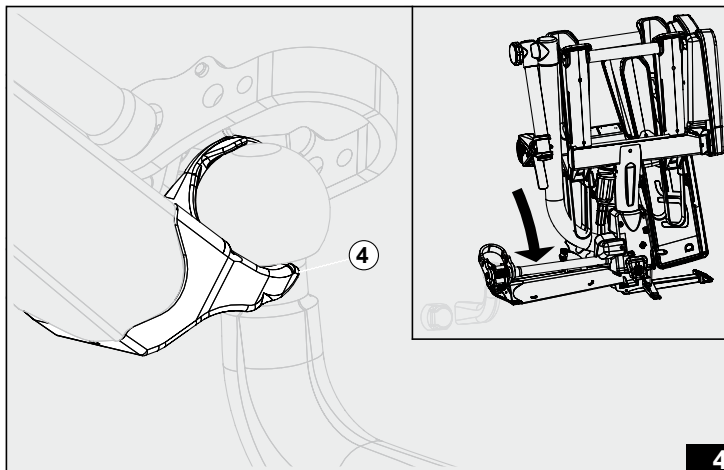

- ☞ Insert the hook (4) of the ball socket of your rear-mounted carrier under the ball of your trailer hitch (fig. 3) (fig. 4).
- ☞ Lower your rear-mounted carrier.
- ➔ Your rear-mounted carrier is attached to the trailer hitch of your vehicle.

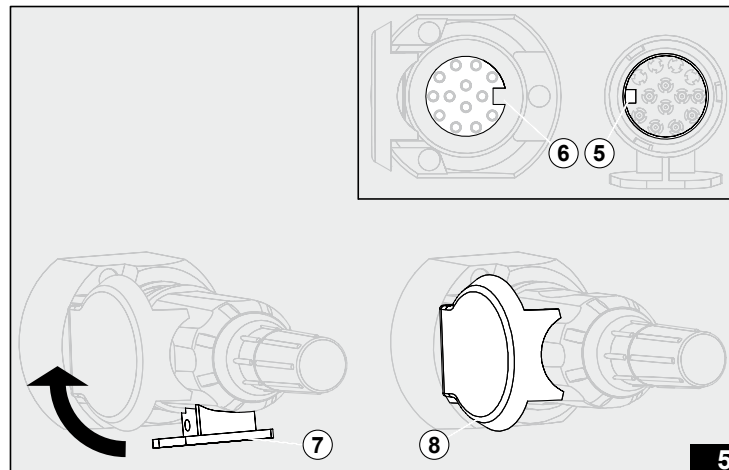

Connecting the carrier

- ☞ Pull the plug out of its holder on the rear-mounted carrier.
- ☞ Place the plug on the trailer socket of your vehicle.
 - ➔ The nose (5) in the plug must be aligned with the slot (6) in the socket (fig. 5).
 - ➔ The locking plate (7) of the plug is at 90° to the cover of your trailer socket – it generally points down or to the left.
- ☞ Rotate the locking plate 90° clockwise.
- ☞ Make sure that the cover (8) of your socket is located correctly above the plug locking plate.

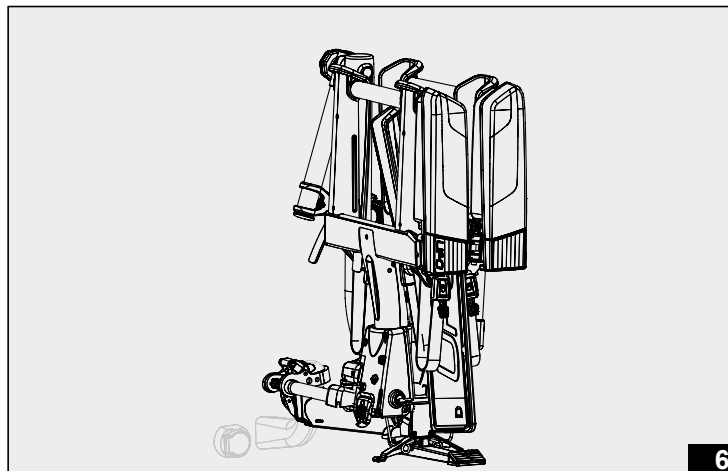

☞ Rotate your rear-mounted carrier in the direction of travel (fig. 6).

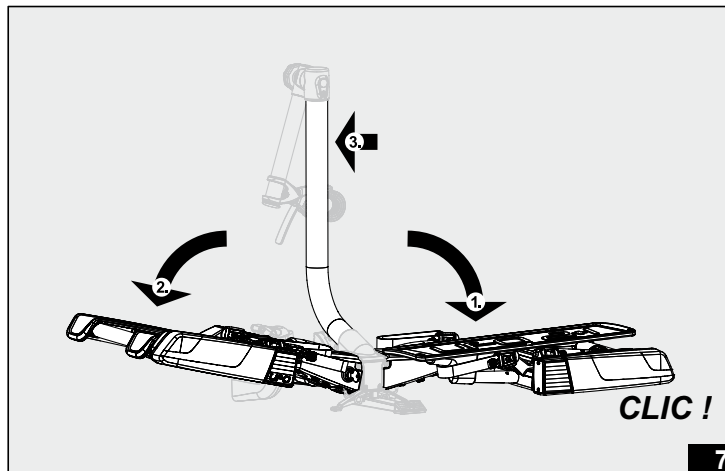

- ☞ Lower the right support arm of your rear-mounted carrier down until it locks (fig. 7).
→ The right support arm is locked.
- ☞ Lower the left support arm of your rear-mounted carrier.
- ☞ Press your rear-mounted carrier briefly once towards the rear of the vehicle by the support tube.
→ The clamping mechanism is aligned to the ball of your trailer hitch.
- ☞ Align your rear-mounted carrier parallel to the rear of your vehicle.

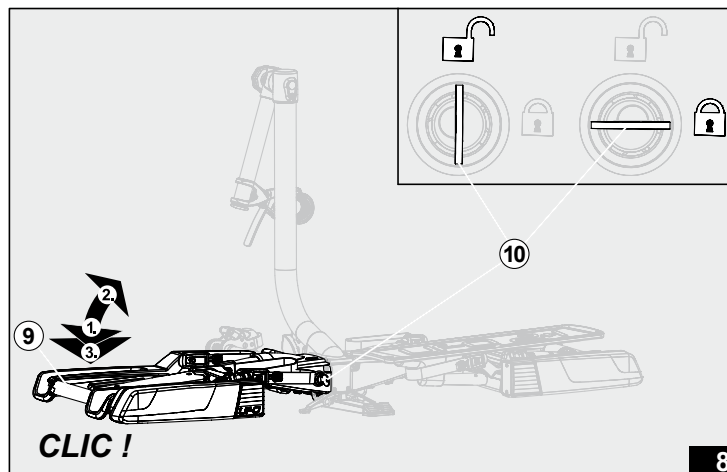

Clamping & locking the carrier

- Press the left support arm of your rear-mounted carrier down by the connecting tube (9) until shortly before it locks.
- ➔ The clamping mechanism is pre-tensioned.
- Pull the support arm up approx. 5 cm.
- Press the support arm forcefully down by the connection tube (9) until it locks (fig. 8).
- ➔ The clamping mechanism is fixed to the ball of your trailer hitch.
- ➔ The left support arm is locked.
- ➔ Your rear-mounted carrier is secured to the trailer hitch of your vehicle.
- Turn the key (10) clockwise to the stop and pull it out (fig. 8).
- ➔ Your rear-mounted carrier is securely locked.

NOTICE

Damage to the rear of the vehicle by contact with rear-mounted carrier or loaded bicycle due to inadequate clamping of the clamping mechanism.

- Make sure that your rear-mounted carrier cannot be rotated on the trailer hitch.
- If necessary, unlock the left support arm (– see **Unlocking support arms**, page 19) and press it down again forcefully until it locks.

① If the left support arm is pressed down immediately until it locks, in rare cases a loud cracking sound may be heard. This is nothing to worry about, nothing is damaged! Repeat the clamping process as described above.

INSTALLATION

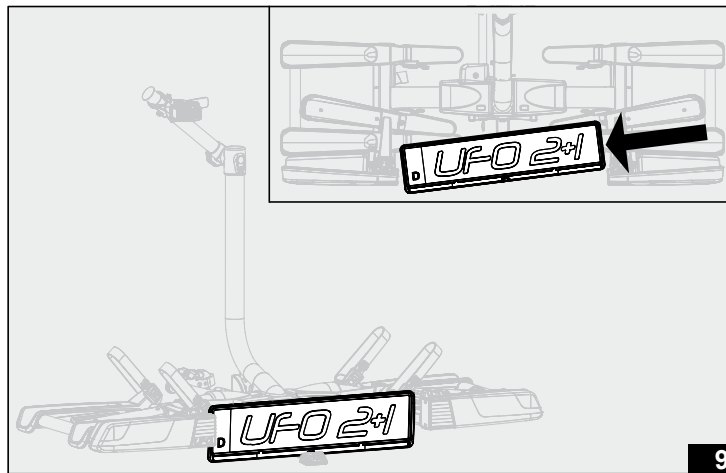

- ☞ Push the number-plate holder to the middle of your rear-mounted carrier (fig. 9).
- ☞ Rotate the number-plate holder to vertical travel position.

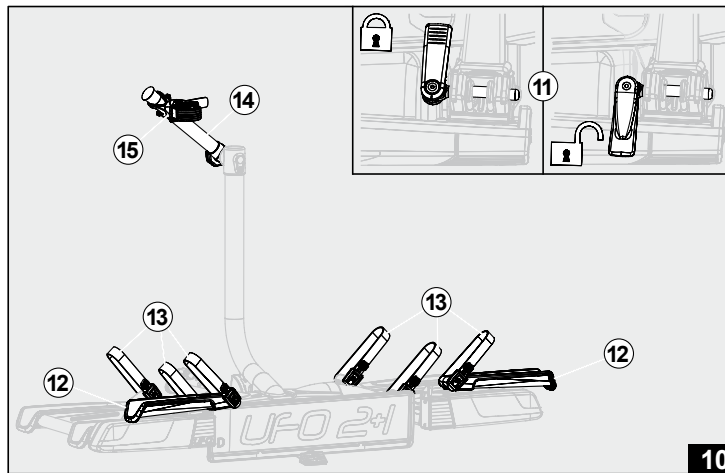

- ☞ Open the extension lever (11) (3rd bicycle) (fig. 10).
- ☞ Move the extension (12) to loading position.
- ☞ Lock the lever.
- ① If you only want to carry 1 or 2 bicycles, it is not necessary to fold down the extension to the position for the 3rd bicycle.
- ☞ Rotate all wheel retainer straps (13) upwards.
- ☞ Rotate the joint arm (14) and the coupling (15) for the 1st bicycle into loading position.
- ☞ Make sure that the lights for your rear-mounted carrier operate correctly (indicator, rear light, brake light etc.).
- ➔ Your I-RACKS rear-mounted bicycle carrier is safely installed on the vehicle and can now be loaded.

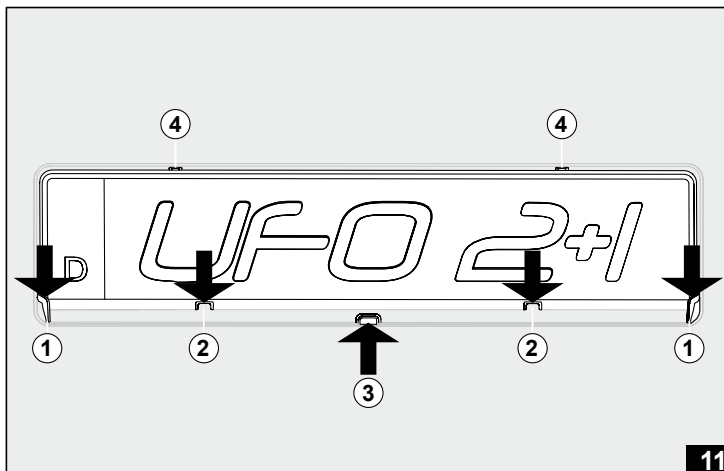

11

INSERTING NUMBER PLATE

- Push your additional number plate under the retainer slots (1) and (2) of the number plate frame (fig. 11).
- ① Push a higher number plate (e.g. Austria) under the retainer slots (1) and (3).
- Carefully lift the top retainer slots (4) with the included mounting plate or a flat screwdriver over the top edge of your additional number plate.

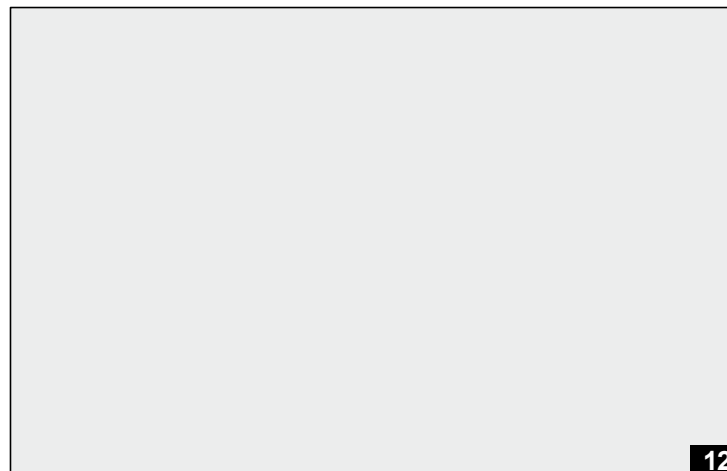

12

THIRD BRAKE LIGHT

- ① German traffic regulations (STVZO) state: "The third brake light of vehicles on vehicle models for which the type approval was issued after 01.10.1998 must not be concealed by luggage racks or loads. The third brake light must be visible to the right and left – viewed from the axis of the vehicle – at a horizontal angle of 10° upwards – starting from the top edge of the light – at a vertical angle of 10° and downwards – starting from the bottom edge of the light – at a vertical angle of 5°. Even if only one of these visual requirements cannot be met, a repeater third brake light is required".

Where applicable, observe the corresponding regulations in your own country or the country where you are holidaying.

- ① You can purchase a third brake light for your I-RACKS rear-mounted bicycle rack from dealers as art. no.: 200 000.

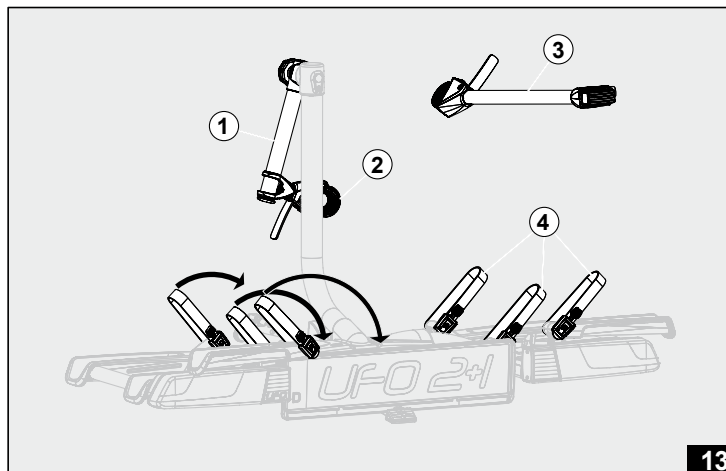

REMOVING REAR-MOUNTED CARRIER FROM THE VEHICLE

- ☞ Rotate the joint arm (1) and the coupling (2) for the 1st bicycle to transport position (fig. 13).
- ☞ Remove the coupling (3) for the 3rd bicycle from the joint arm.
- ☞ Rotate all wheel retainer straps (4) inwards.

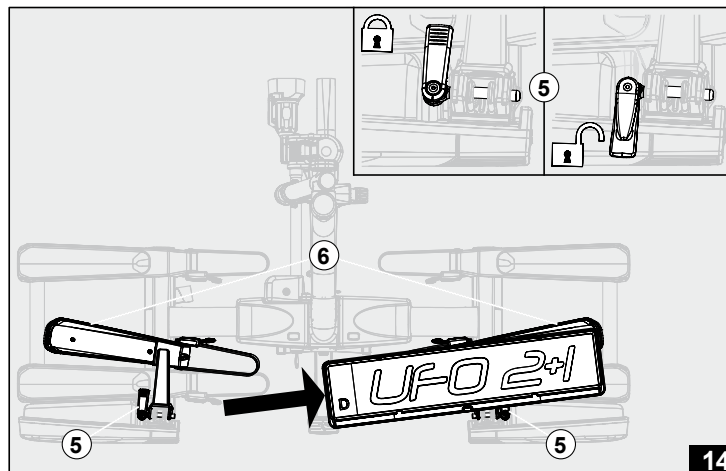

- ☞ Open the lever (5) of the extension (6) (3rd bicycle) (fig. 14).
- ☞ Fold the extension to transport position.
- ☞ Lock the lever.
- ☞ Rotate the number-plate holder to the horizontal position.
- ☞ Push the number-plate holder right to the stop.

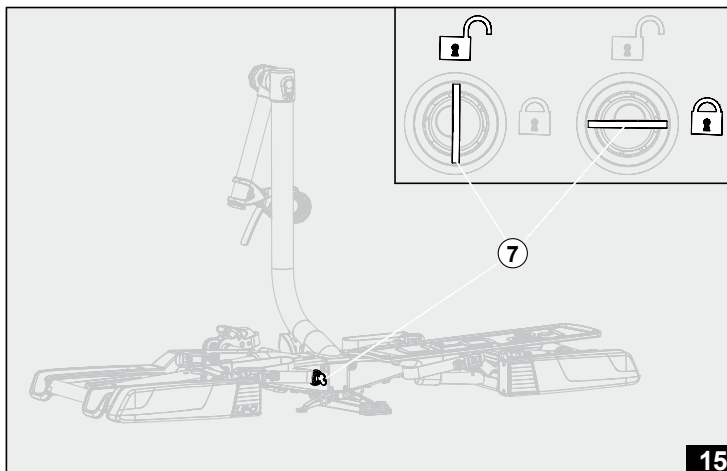

15

Unlocking support arms

- ☞ Turn the key (7) anticlockwise to the stop (fig. 15).
- The lock of your rear-mounted carrier is released.
- The key cannot be removed.

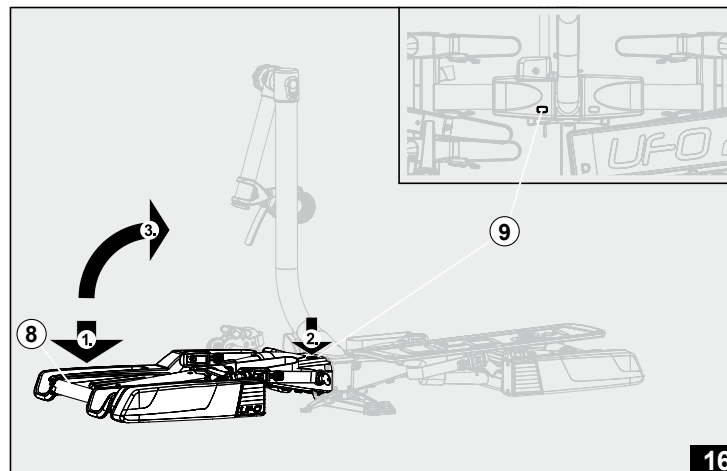

16

- ☞ Press the left support arm on the connecting tube (9) forcefully down and hold it down (fig. 16).
- The clamping mechanism is released.
- ☞ Press the left release (9) and release the support arm.
- The left support arm is unlocked.
- ☞ Swing the left support arm to transport position.

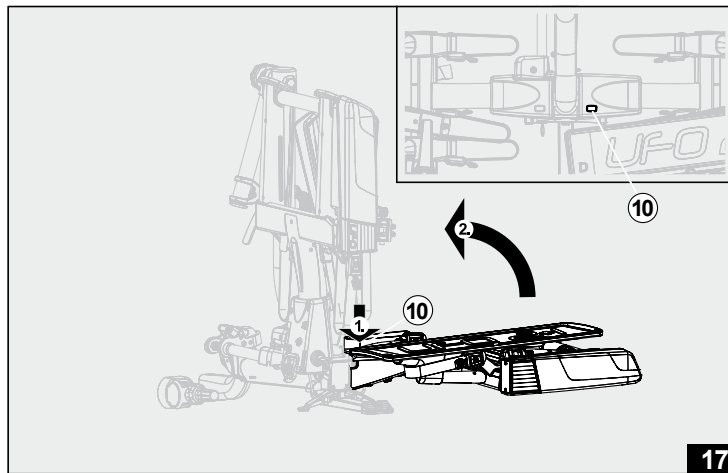

- ☞ Press the right release (10) (fig. 17).
- ☞ Swing the right support arm to transport position.

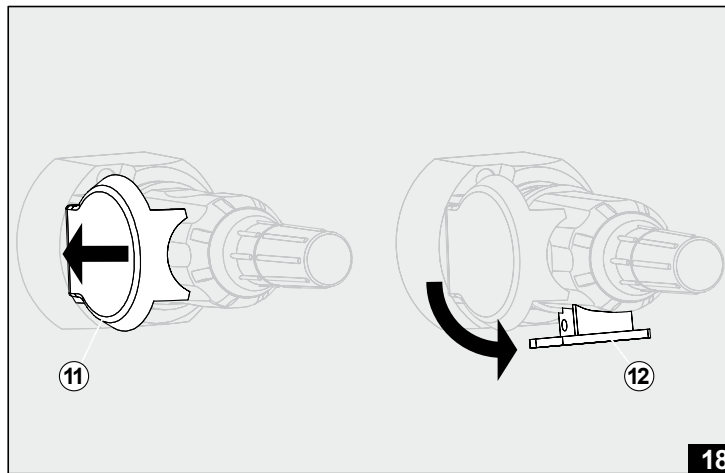

- ☞ Lift the cover (11) of your trailer socket slightly (fig. 18).
- ☞ Rotate the locking plate (12) of the plug 90° anticlockwise.
- ☞ Pull the plug out of the trailer socket of your vehicle.
- ☞ Insert the plug into its holder on the rear-mounted carrier.

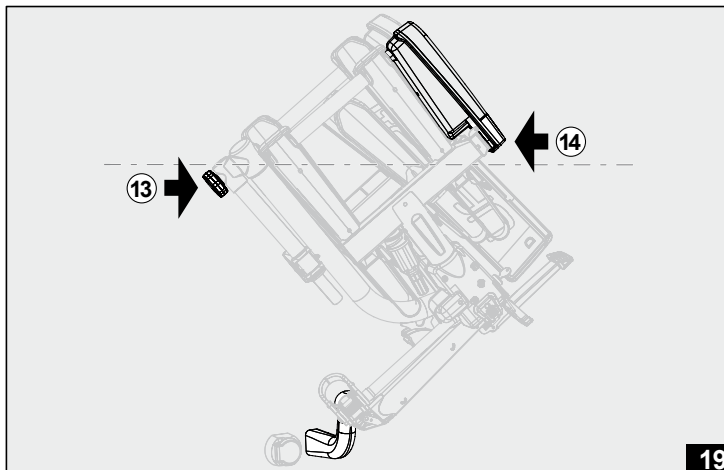

- ☞ Rotate the rear-mounted carrier approx. 80° clockwise.
- ☞ Stand behind the trailer hitch of your vehicle.
- ☞ Hold your rear-mounted carrier by the star handle (13) of the re-tainer arm with your left hand and hold the bottom edge of the housing of the rear light (14) (fig. 19) with your right hand.
- ☞ Remove the rear-mounted carrier from the trailer hitch of your vehicle in the same position as for mounting it.
 - ➔ Your hands and the holding points of your rear-mounted carrier will be at about the same height (fig. 19).
 - ➔ The central tube (15) of your rear-mounted carrier will be at an angle of about 10° to the rear bumper of your vehicle (fig. 20).

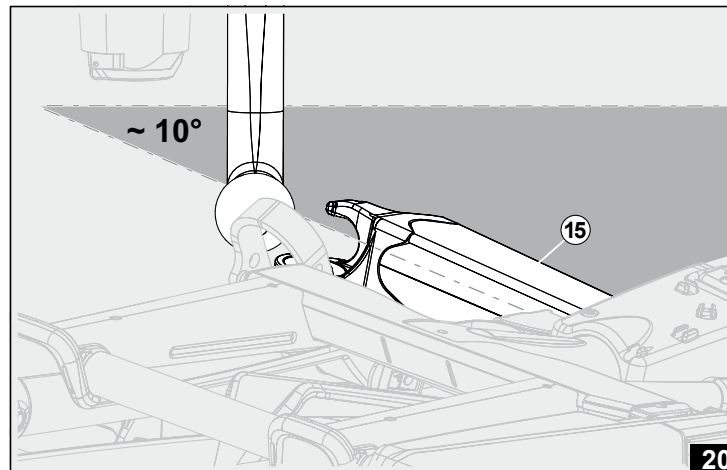

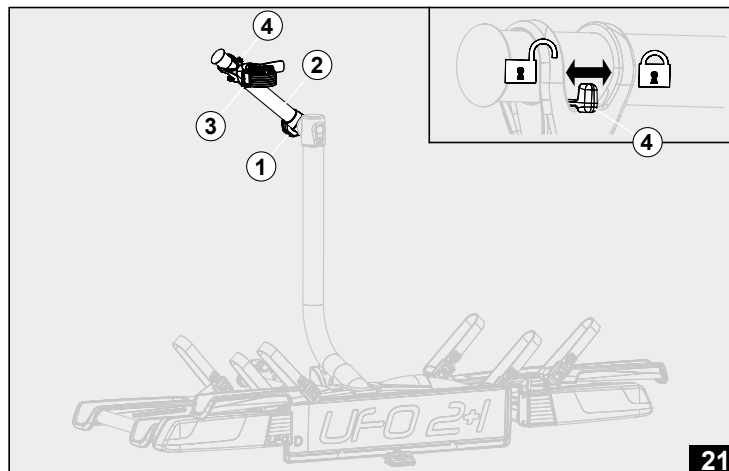

21

LOADING REAR-MOUNTED CARRIER

⚠ WARNING

Risk of accident due to parts falling off due to incorrect or non-approved loading.

- Read and observe the **BASIC SAFETY INSTRUCTIONS** – see ... **LOADING**, page 10.

- ☞ Unscrew the star handle (1) of the joint arm (2) (fig. 21).
- ☞ Move the joint arm and the coupling (3) for the 1st bicycle to loading position.
- ☞ Tighten the star handle (1) of the joint arm loosely at first.
- ① You can use the lever (4) to fix or release the belt for the 1st bicycle – but the coupling can still be moved even in its fixed position.

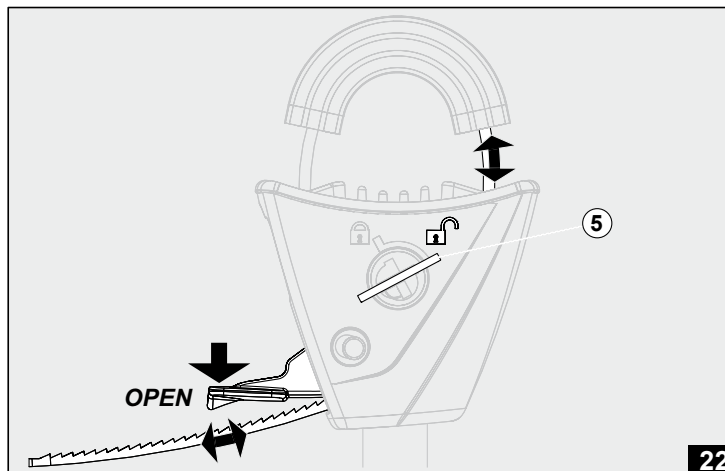

22

Using coupling head

Pulling out/inserting tension strap (fig. 22):

- ☞ Turn the key (5) clockwise to the stop.
 - ➔ The coupling head is locked.
 - ➔ The key cannot be removed.
- ☞ Hold the lever in the OPEN position.
 - ➔ The tension strap can be pulled right out of the coupling head or inserted.
- ① Do not press the clamping lever to the top, because this will jam the tension strap and it will be impossible to move it.

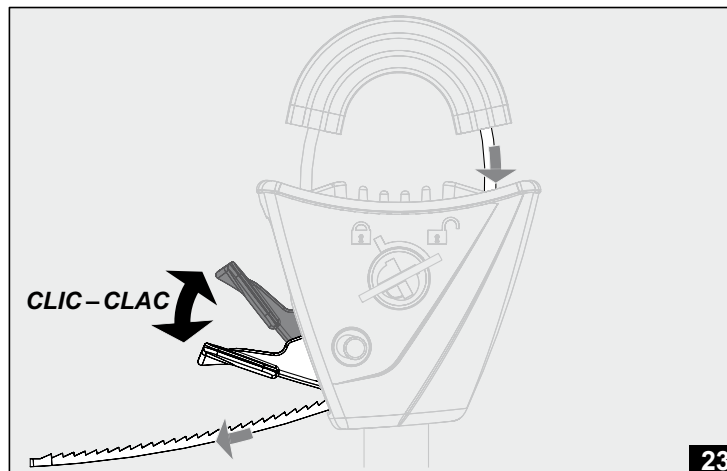

23

Tightening tension strap (fig. 23):

- ☞ Actuate the lever.
- ➔ The tension strap is pulled in and tightened.

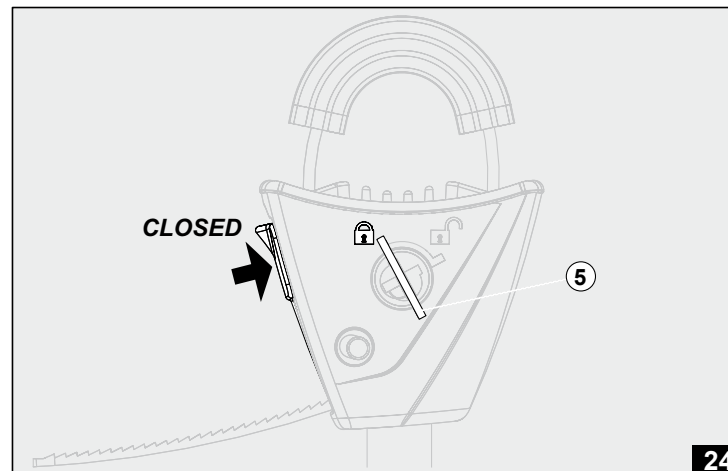

24

Close coupling head (fig. 24):

- ☞ Turn the key (5) anticlockwise to the stop.
- ➔ The coupling head is locked.
- ➔ The key can be removed.
- ① If the lever is not pressed into the CLOSED position, it can still be operated, even with the key removed!
This is useful when you want to tighten the tension straps at the end after all bicycles have been loaded.
- ☞ Press the lever to the CLOSED position.
- ➔ Coupling head and lever are locked – your bicycle is protected from theft.

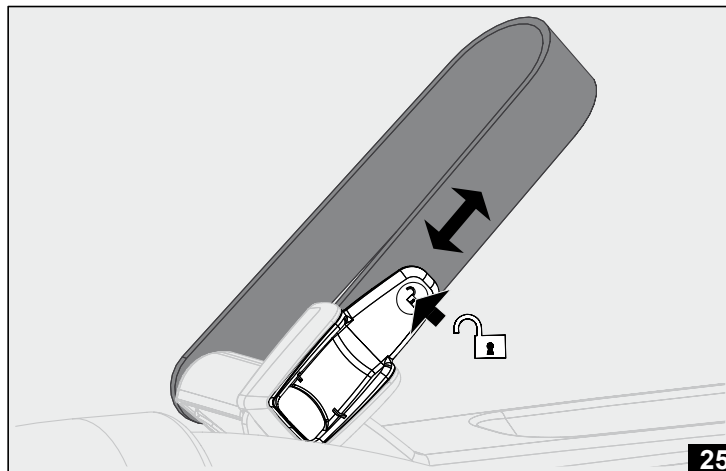

25

Operating wheel retainer strap

Removing/inserting retainer strap (fig. 25):

- ☞ Press and hold the button of the wheel retainer strap.
- ➔ The wheel retainer strap can be pulled completely out of the buckles or easily inserted – without locking.

Tightening wheel retainer strap (fig. 25):

- ☞ Press and hold the button of the wheel retainer strap.
- ☞ Push the wheel retainer strap into the buckle until it is in contact with the rim.
- ☞ Release the button of the wheel retainer strap.
- ☞ Pull the wheel retainer strap to its end.

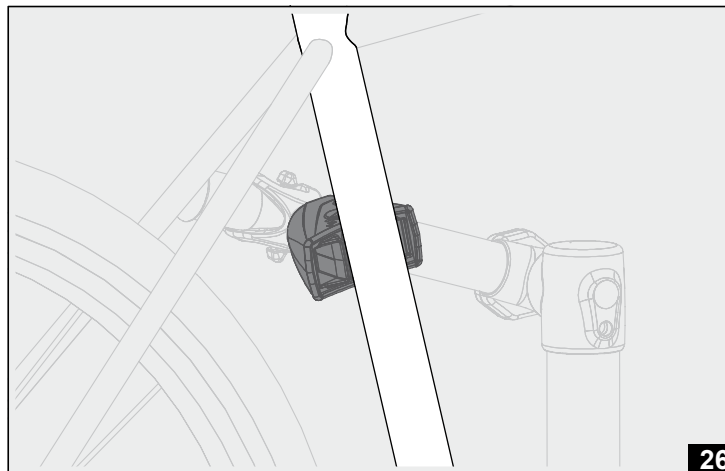

26

Attaching first bicycle

- ① If you wish to load several bicycles on your rear-mounted carrier, always load the heaviest bicycle first. If different bicycles weigh the same, start with the largest.
- ① Close coupling head and tension strap – see **Using coupling head**, page 22.
- ☞ Pull the wheel retainer straps out of the buckles.
- ☞ Pull the tension strap out of the coupling head.
- ☞ Place the 1st bicycle on the 1st rack.
- ☞ Make sure that the seat tube of your bicycle is correctly positioned in the coupling head holder – adjust the joint arm and coupling if necessary (fig. 26).
- ➔ The coupling for the 1st bicycle is in the direction of travel.
- ➔ The seat tube of the 1st bicycle is precisely fitted in the coupling head.

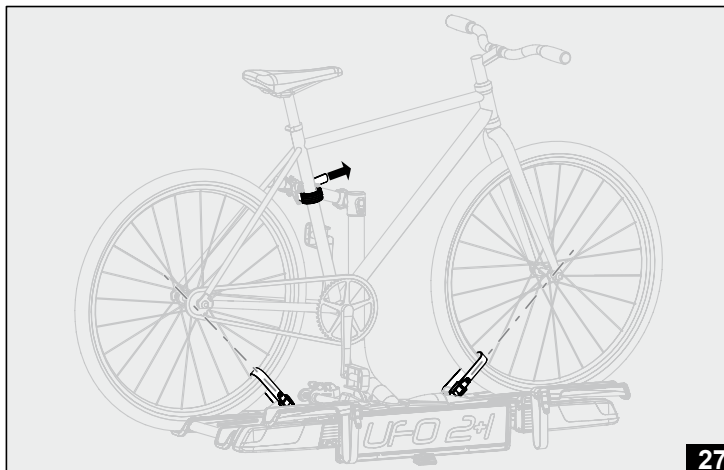

27

- ☞ Place the tension strap around the seat tube of your bicycle.
- ☞ Insert the tension strap through the coupling head.
- ☞ Tighten the tension strap at its end by hand.
- ☞ Tighten the star handle (1) of the joint arm (fig. 21).
- ☞ Press the lever (4) to the right.
- ➔ Joint arm and coupling are secure.
- ☞ Tighten the tension strap until it is tightly wrapped around the seat tube of your bicycle.
- ☞ Close the coupling head.
- ☞ Position the wheel retainer straps so they point in the direction of the centre of the wheels (hubs) (fig. 27).
- ☞ Tighten the wheel retainer straps – see **Operating wheel retainer strap**, page 24.
- ➔ The 1st bicycle is securely attached.

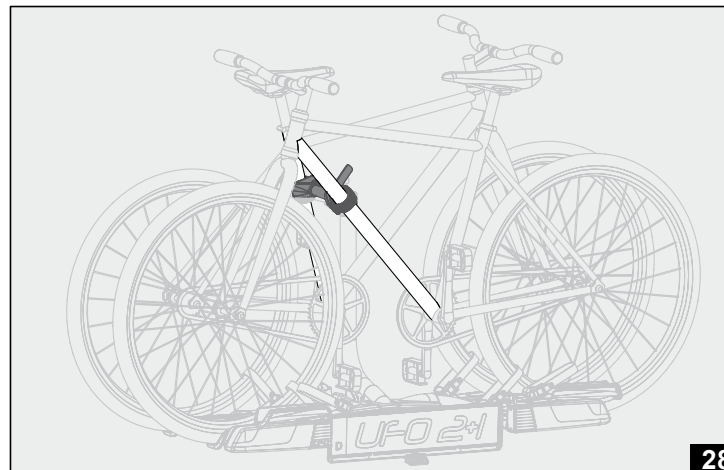

28

Attaching second bicycle

- ☞ Fasten the coupling for the 2nd bicycle to the seat tube of the 1st bicycle – as close as possible under or over the coupling the 1st bicycle.
- ☞ Pull the wheel retainer straps out of the buckles.
- ☞ Pull the retainer strap out of the coupling head.
- ☞ Place the 2nd bicycle on the 2nd rack.
- ☞ Make sure that the bottom tube of the 2nd bicycle is correctly positioned in the receptacle of the coupling head – adjust the coupling if necessary.
- ➔ The coupling for the 2nd bicycle is in the direction of travel.
- ➔ The bottom tube of the 2nd bicycle is precisely fitted in the coupling head.
- ☞ Continue as with the 1st bicycle.
- ➔ The 2nd bicycle is securely attached.

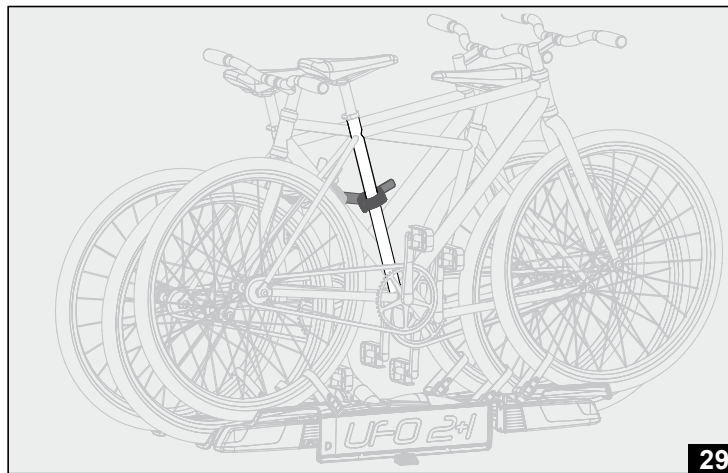

29

Attaching third bicycle

- ☞ Fasten the coupling for the 3rd bicycle to the joint arm of your rear-mounted bicycle carrier – between the coupling for the 1st bicycle and the joint of the joint arm (fig. 29).
- ☞ Pull the wheel retainer straps out of the buckles.
- ☞ Pull the tension strap out of the coupling head.
- ☞ Place the 3rd bicycle on the rack of the extension.
- ☞ Make sure that the seat tube of the 3rd bicycle is correctly positioned in the receptacle of the coupling head – adjust the coupling if necessary.
 - The coupling for the 3rd bicycle is in the direction of travel.
 - The seat tube of the 3rd bicycle is precisely fitted in the coupling head.
- ☞ Continue as with the 1st bicycle.
- The 3rd bicycle is securely attached.

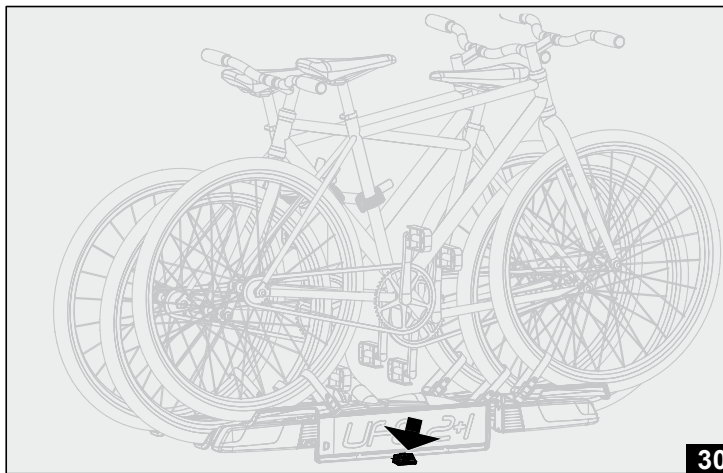

30

PIVOTING REAR-MOUNTED CARRIER

- ☞ Hold your rear-mounted bicycle carrier by a fixed point on one of the loaded bicycles – e.g. a frame tube near the coupling head.
- ☞ Press the unlocking pedal (fig. 30).

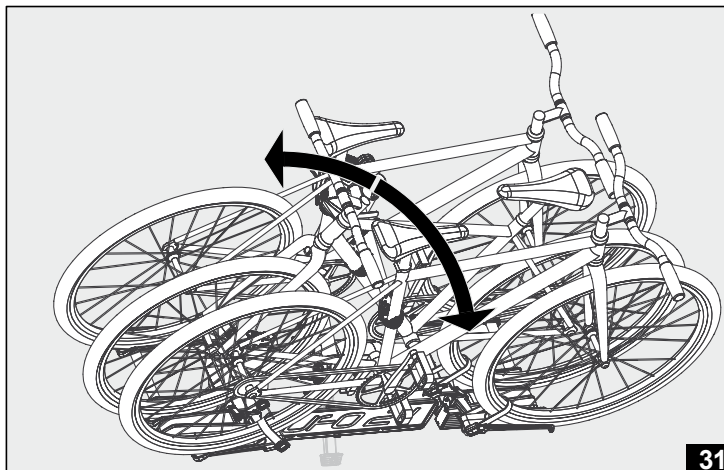

NOTICE

Damage to vehicle rear hatch by contact with rear-mounted carrier or bicycle on carrier.

- Make sure that the rear hatch does not contact the rear-mounted carrier when it is pivoted aside or a bicycle is loaded on the carrier.
- If necessary, disable the automatic hatch opener on your vehicle for additional safety. This will prevent the hatch from opening if the rear-mounted carrier is not swung aside.

☞ Pivot your rear-mounted bicycle carrier slowly down to the stop (fig. 31).

→ Now you can open the rear hatch of your vehicle.

☞ Close the rear hatch of your vehicle.

☞ Press your rear-mounted bicycle carrier at a stable point on one of the loaded bicycles until it comes up and locks – e. g. a frame tube near a coupling head.

→ Your rear-mounted bicycle carrier is once again securely locked in travel position – you can continue driving.

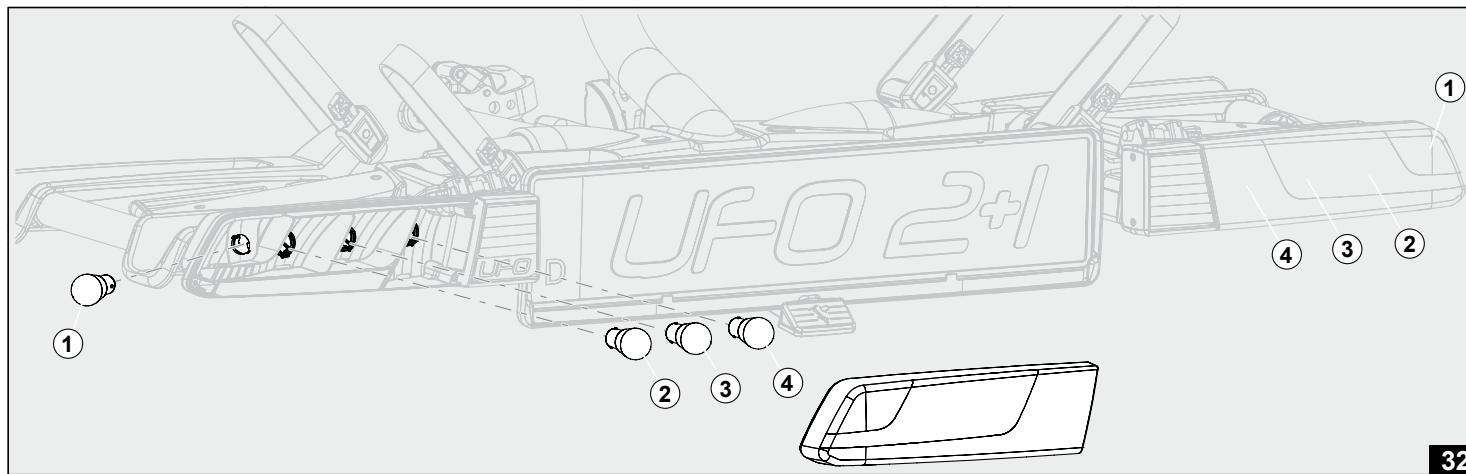

REPLACING LIGHTS

- Unscrew the 3 screws on the housing until the lens can be removed – the screws remain in the housing!
- ① The globes have a standard bayonet connection.
- Press the globe in.
- Turn it 35° anticlockwise.
- Remove the globe from the socket.
- Insert a new globe and press it in.
- Turn it 35° clockwise.
- Make sure that the globe is securely seated in the socket.
- Wipe the globe with a clean dry cloth.
- Test the new globe before replacing the lens.

(1) Rear light/brake light – **12V P 21 W/5W**

(2) Indicator – **12V PY 21 W**

(3) Reversing light – **12V P 21 W**

(4) Rear fog light – **12V P 21 W**

⚠ WARNING

Risk of accident due to failure of rear-mounted carrier because of faulty or unapproved installation or maintenance.

– Read and follow the **BASIC SAFETY INSTRUCTIONS** – See ... INSTALLATION & MAINTENANCE, page 9.

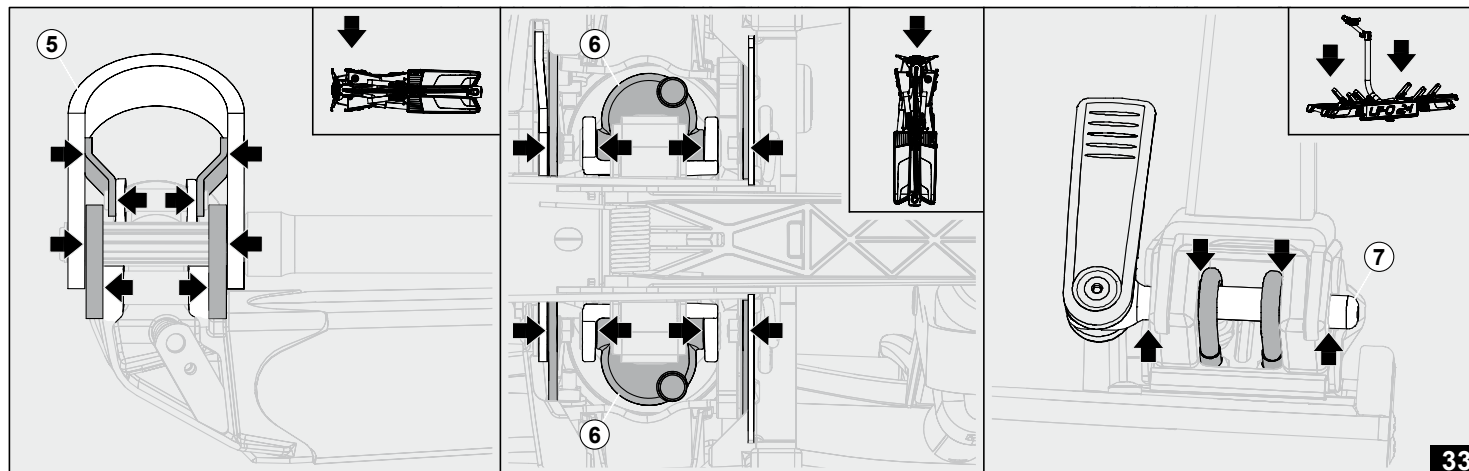

33

INTERVALS

- ① The service intervals for your I-RACKS product depend on how frequently you use the product and also the weather conditions under which it is used. Service the product more frequently if you use your I-RACKS product under extreme conditions (rain, dirt, travelling long distances etc.).

When you perform your regular services, make sure that your I-RACKS product is always cleaned thoroughly with the correct cleaning and care products and is correctly lubricated with the correct lubricants.

See a dealer for information on suitable lubricants and cleaning and care products and how to use them correctly.

- ① Always use high-quality, viscous, acid-free and non-resinous lubricating oil (e.g. bicycle chain oil) – 2–3 drops for every marked point.

- ☞ Clean your rear-mounted bicycle carrier regularly with water and a neutral cleaning agent (e.g. car shampoo).
- ☞ Always allow your rear-mounted bicycle carrier to dry completely before storing it in the carrying case.
- ☞ Regularly oil the marked points of the joints of the clamp mechanism (5) and the support arms (6) (fig. 33).
- ☞ Regularly oil the eccentric shaft (7) of the two clamp levers of the extensions (3rd bicycle).
- ☞ Wipe away excess oil after about 5 minutes.

NOTICE

Damage to vehicle rear hatch by contact with rear-mounted carrier or bicycle on carrier because clamp mechanism is insufficiently tightened.

- Make sure that the contact areas of the clamp mechanism to the coupling ball are free from lubricants.

TYPE APPROVAL



Vehicle Technology Division

THE NETHERLANDS
(NEDERLAND)



COMMUNICATION

Concerning ⁽¹⁾:

- approval granted
- approval extended
- approval refused
- approval withdrawn
- production definitely discontinued

of a separate technical unit type of luggage rack, ski rack or radio receiving or transmitting aerial ⁽¹⁾.

Approval number: E4-26R-03 0331

Extension number: 00

1. Trade name or mark : I-Racks GmbH
2. Type : TBR-F
3. Manufacturer's name and address : I-Racks GmbH
Hauptstraße 3/1
88284 Wolpertswende
Germany
4. If applicable, name and address of manufacturer's representative : n/a
5. Characteristics of the separate technical unit : Separate technical unit / Type of luggage rack
6. Limitations of use, if any, and assembly instructions : see Appendix 1 (Information folder); Annex 2:
Conditions and advices, limitations of use
7. Specimen required for approval of a separate technical unit submitted on : 2014-06-16
8. Technical service conducting approval tests : TÜV Rheinland Kraftfahrt GmbH
Am Grauen Stein
51105 Köln
Germany

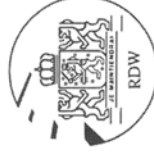

P.O. Box 777
2700 AT Zoetermeer
The Netherlands
Tel + 31 (0)79 345 83 02
E-mail tnv@rdw.nl
www.rdw.nl

Vehicle Admission & Surveillance

External projections component R26.03 v5.01

Page 1 of 2

Approval number: E4-26R-03 0331

Extension number: 00

9. Date of report issued by that service : 2014-12-12
10. Number of report issued by that service : 143NB0019-00
11. Approval for separate technical unit has been granted/extended/refused/withdrawn ⁽¹⁾ in respect of luggage rack(s), ski rack(s), radio receiving or transmitting aerial(s) ⁽¹⁾.
12. Place : Zoetermeer
13. Date : 13-FEB-2015
14. Signature :  **R. F. R. Clement**
15. The list of documents filed with the administration service which has granted approval and available on request is attached to this communication.

⁽¹⁾ Strike out what does not apply.

© I-RACKS GmbH 2014

ALL RIGHTS RESERVED

580 000 – 12-2014

UMSCHLAG & INHALT:

WWW.TECHNISCHE-REDAKTION.DE

I-RACKS
automotive
transport systems **GmbH**